

THE INFORMATION CONTAINED IN THIS DRAWING IS THE SOLE PROPERTY OF ANDERSON POWER PRODUCTS. ANY REPRODUCTION IN PART OR WHOLE WITHOUT THE WRITTEN PERMISSION OF ANDERSON POWER PRODUCTS IS PROHIBITED.

Copyright 2013

ANDERSON POWER PRODUCTS RESERVES THE RIGHT TO ALTER PRODUCT TYPES, THEIR TECHNICAL DATA, DIMENSION, STYLE AND ACCESSORIES WITHOUT PRIOR NOTIFICATION.

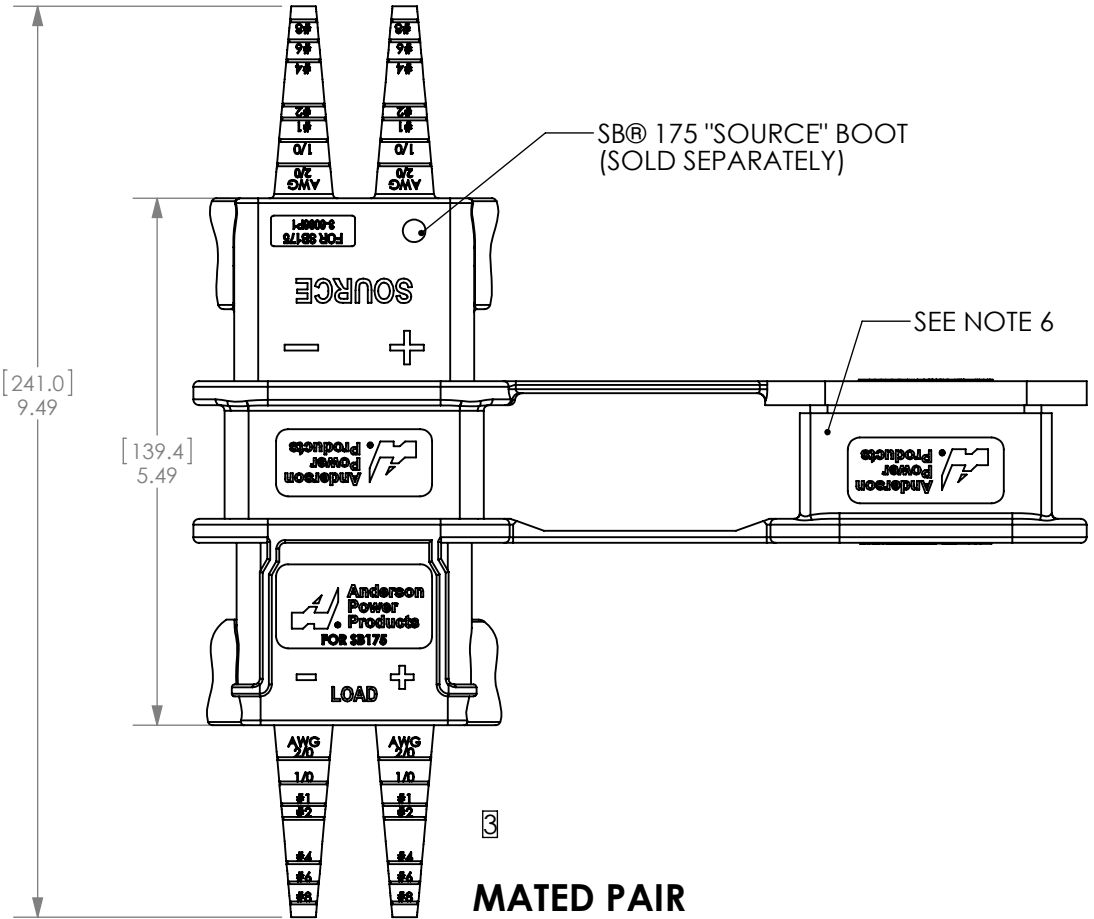
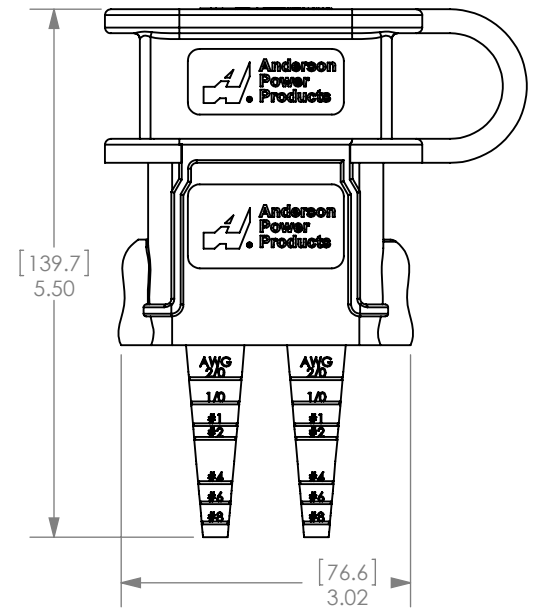
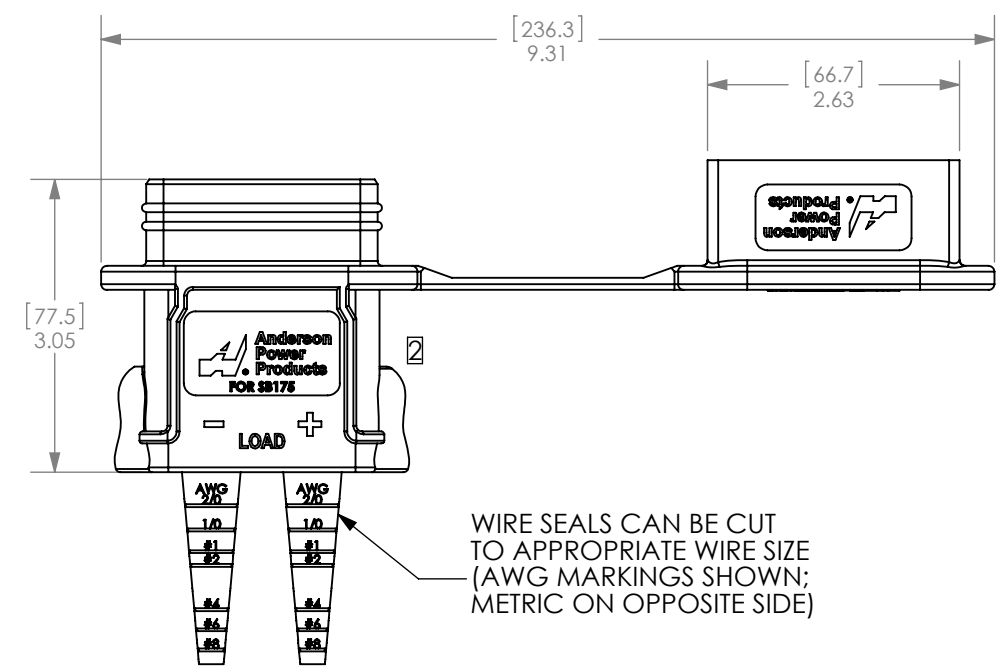
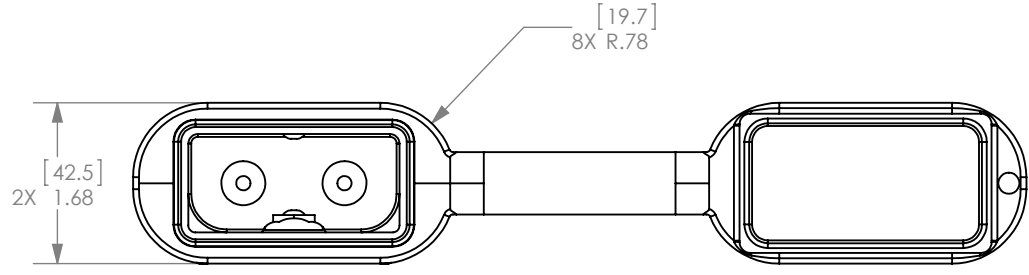
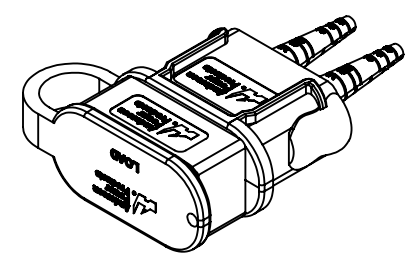
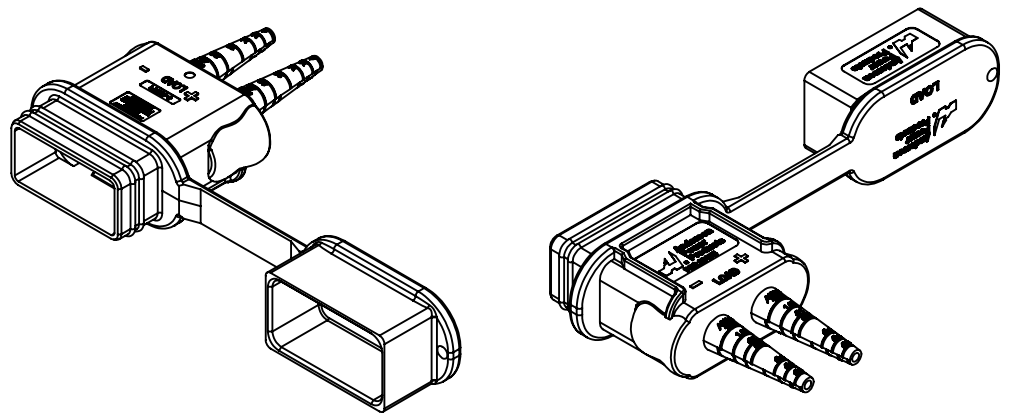

- NOTES:
- MATERIAL - TPE
  - INTENDED FOR USE WITH SB@175 CONNECTOR SERIES (SOLD SEPARATELY)
  - REFER TO THE FOLLOWING ASSEMBLY INSTRUCTIONS: 1S1030A FOR SB@ CONNECTOR SERIES 1S6596 FOR SB@ ENVIRONMENTAL BOOTS
  - "LOAD" BOOT INTENDED FOR USE WITH CONNECTOR ATTACHED TO ELECTRICAL LOAD
  - IN THE UNMATED CONDITION, SECURE THE COVER TO THE BOOT FOR ENVIRONMENTAL PROTECTION
  - IN THE MATED CONDITION, SECURE COVERS TOGETHER TO PREVENT PARTICULATES FROM GATHERING IN THE COVERS

| REV. | DESCRIPTION                         | APPRV | DATE       |
|------|-------------------------------------|-------|------------|
| 4    | ECRN 15779                          | CMS   | 2/23/2015  |
| 3    | ECRN 15737- TEXT CHANGE SOURCE BOOT | CMS   | 11/5/2014  |
| 2    | ECRN 15678                          | CMS   | 7/25/2014  |
| 1    | ECRN 15518A                         | NTS   | 12/03/2013 |

| DIMENSIONS ARE IN:      | INCH [MM]     | APPROVALS |                |
|-------------------------|---------------|-----------|----------------|
| UNLESS OTHERWISE STATED |               | DRAWN     | LLD 5/6/2013   |
| TOLERANCES:             |               | CHECKED   | CMS 5/6/2013   |
| DECIMALS (INCH)         | DECIMALS (MM) | MFG APPRV | CHB 5/6/2013   |
| .XX ± .02               | .X ± .5       | QC APPRV  | UFN 10/14/2013 |
| ANGLES                  | ±2°           | ENG APPRV | BD 10/14/2013  |
| SURFACE FINISH:         |               |           |                |
| MACHINED                | 128µin [3.2µ] |           |                |
| MOLDED                  | 64µin [1.6µ]  |           |                |
| MATERIAL:               | SEE NOTE # 1  |           |                |
| FINISH:                 |               |           |                |

**ANDERSON POWER PRODUCTS**

TITLE: **OUTLINE DRAWING SB@175 ENVIRONMENTAL BOOT WITH COVER LOAD BOOT P/N: 3-6037P1**

SIZE: **B** DWG NO.: **B02173S1** REV.: **4**

SCALE: **NONE** CADFILE: **03942** SHEET: **1 OF 1**

-CAD GENERATED DRAWING- DO NOT MANUALLY UPDATE DO NOT SCALE